



Carl House | Commonside Road | Harlow | CM18 7SL

Asking Price £195,000



Carl House | Commons Road

Harlow | CM18 7SL

Asking Price £195,000

A NEWLY REDECORATED ONE BEDROOM GROUND FLOOR FLAT with private garden. The property comprises of an entrance hall, double bedroom, open plan lounge kitchen diner and a family bathroom suite. Other features include gas heating via radiators, UPVC double glazing, well kept communal lobby with secure access and allocated parking to rear. Viewings advised.

- Ground Floor Flat
- Private Garden
- Council Tax Band: B
- One Double Bedroom
- Allocated Parking
- EPC Rating: C

Communal Lobby

Secure entry door. Well kept and maintained lobby.

Entrance Hall

3'6" x 7'3" (1.07m x 2.21m)

External door to communal lobby. Internal doors to living room, bedroom, family bathroom and storage cupboard. Newly fitted grey carpet.





Living Room

14'2" x 10'9" (4.32m x 3.28m)

UPVC double glazed window and door to private garden. Two radiators to walls. Internal door to entrance hallway. Newly fitted grey carpet. Open-plan to kitchen.

Kitchen

11'2" x 5'8" (3.40m x 1.73m)

UPVC double glazed window looking into garden. White wall and base units with laminate worktops, stainless steel cooker hood and stainless steel sink and drainer. Gas combination boiler to wall. Space for cooker and fridge freezer. Plumbing for washing machine. Tiled floor. Open-plan to living room.

Bedroom

9'11" x 13'0" (3.02m x 3.96m)

UPVC double glazed window to front, radiator to wall. Newly fitted grey carpet. Internal door to entrance hall.

Bathroom

6'5" x 5'8" (1.96m x 1.73m)

White three piece suite with shower attachment over bath. Chrome heated towel rail to wall. Tiled floor. Extractor fan. Internal door to entrance hall.

Garden

15'0" x 18'0" approx (4.57m x 5.49m approx)

South-facing rear garden mostly laid to lawn. Timber gate onto rear carpark.

Car Park

To the rear of the block is a carpark with an allocated space and access into garden via timber gate.

Lease Information

The below figures have been provided to us by the vendors:

Service Charge: £418.75 per annum

Ground Rent: £150 per annum

Lease: 995 years remaining

Local Area

Carl House is a private development located off Commonsidge Road. Maunds Hatch is only 0.1 miles away benefiting from a convenience store (The Co-operative Food) as well as local schooling and children's play areas close by.



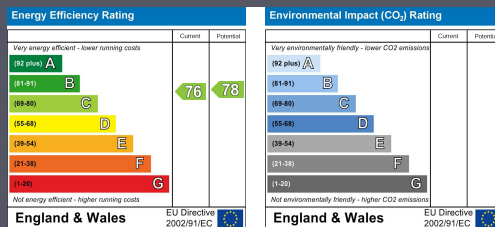
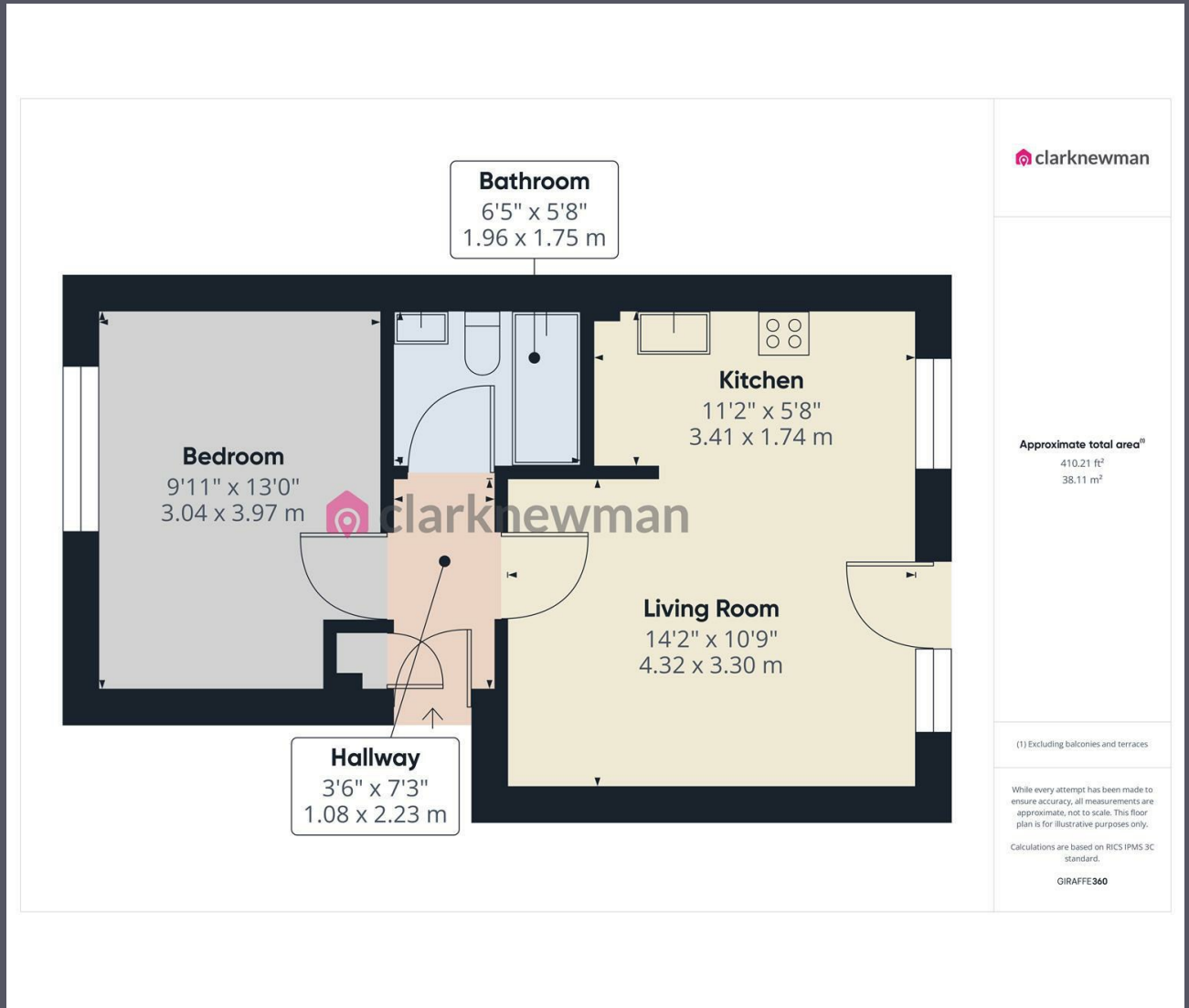

Equity House
4-6 Market Street
Harlow
Essex
CM17 0AH
01279 400444
hello@clarknewman.co.uk
www.clarknewman.co.uk